

SMB AI-Systems & High-Speed Interconnect

Steel cable tray bends



Steel cable tray bends



Students trading aid on how best to put an internal 90 degrees bend in steel cable tray. Includes a full demonstration on how bend steel cable tray using a crimping to.

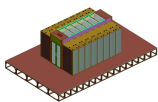

Cablobend Systems give you the freedom for true cable tray flexibility. Create bends and drops that you need—without cutting. Perfect for data centers.



RKS-Magic® Quick Install Trough Tray The RKS-Magic® system features our patented Magic Connection System, providing rapid, screwless connections. A comprehensive range of fittings with ...



Crafted from premium materials such as galvanized steel, aluminum, and stainless steel, our bends are designed to withstand heavy loads, resist corrosion, and maintain long-lasting performance. Each ...

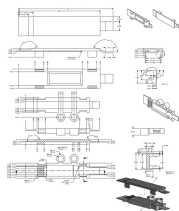

HellermannTytonGÇÖs low voltage raceway (TSR) is a one piece, non-metallic, adhesive backed, latching raceway designed to aesthetically organize and route communications wires, including high ...



The Ladder Tray features light, rugged, tubular steel construction. It is designed for mechanical support and strain relief in long runs of cable and creates a smooth gradual bend for cable.



Cable Tray Fitting, 90° Junction Kit. Material: Carbon Steel. Finish: Electroplated Zinc. Includes: (1) Hardware for (1) Tee (2) 90° Bends.



90° bend, Vertical Inner Bend, for all cable tray types of 50 mm side height. Including appropriate fastening material.



Choose from our selection of cable trays, including over 850 products in a wide range of styles and sizes. Same and Next Day Delivery.



We offer a variety of cable tray flat bends available for light, medium, and heavy duty cable tray systems in varying sizes to suit your requirements.

Contact Us

For more information, pricing, or custom solutions, please contact us:

Website: <https://samastersbaseball.co.za>

Email: sales@samastersbaseball.co.za

Phone: +27 63 874 2095

Address: 15 Innovation Drive, Technopark, Stellenbosch, 7600, South Africa

This document is for informational purposes only. Specifications subject to change without notice.

