

## Distribution Box Incoming and Outgoing Line Connection Method

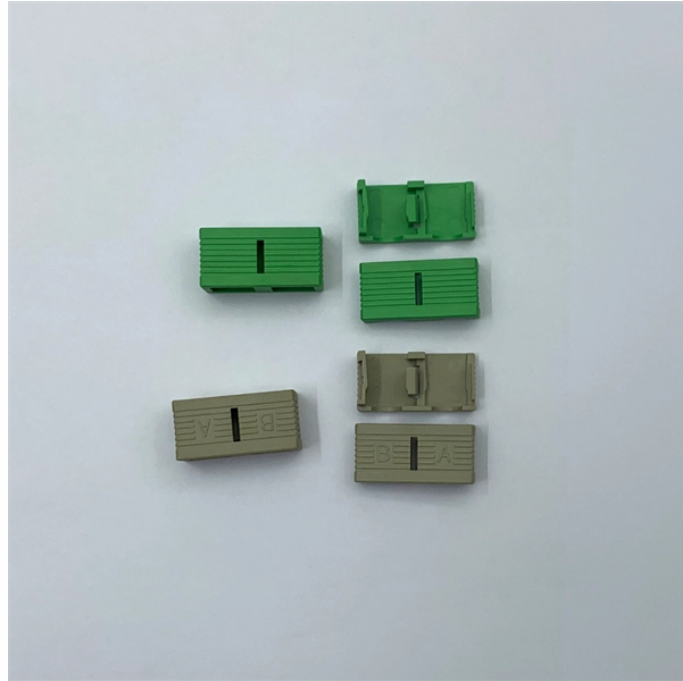

## Distribution Box Incoming and Outgoing Line Connection Method



Hey, in this article we are going to see the Single Phase Distribution Box Wiring Diagram and Connection Procedure. A distribution board or distribution box is where the main power supply is ...

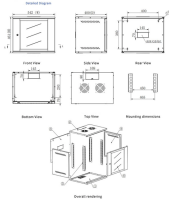

Trace the outgoing line circuit: Analyze the outgoing line circuits of the distribution box one by one, understand the load equipment and protection method of each circuit, and ensure that each ...

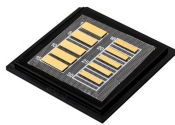

The utility model discloses a line incoming and outgoing structure of a power distribution box.

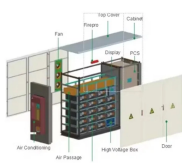

Power distribution panel power supply is received from LT panel. MCCB is used for making and breaking incoming power where ACB incomer supply is connected with LT panel and outgoing is connected ...

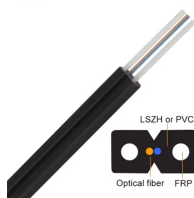

Explore a comprehensive guide to residential electric meter box wiring diagrams, offering clear instructions for safe and efficient installation.

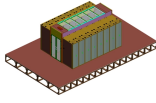

The utility model discloses a power distribution box incoming and outgoing line structure. The back wall of a power distribution box is provided with hoisting lug type hoisting...



Whether you're an electrician or a DIY enthusiast, this tutorial will help you understand the fundamentals of wiring a distribution box for a residential setup.



This technical article describes single line diagrams of two typical power substations 66/11 kV and 11/0.4 kV and their power flow, principles of incoming lines (incomers) and outgoing ...



The function of the electric power distribution system in a building or an installation site is to receive power at one or more supply points and to deliver it to the lighting loads, motors and all other ...

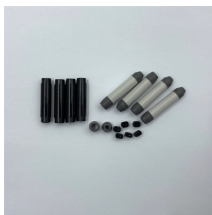

Just like you wouldn't want a weak or clogged artery in your body, you don't want subpar incoming lines feeding your distribution box. We'll walk through everything you need to consider, ...

## Contact Us

For more information, pricing, or custom solutions, please contact us:

Website: <https://samastersbaseball.co.za>

Email: [sales@samastersbaseball.co.za](mailto:sales@samastersbaseball.co.za)

Phone: +27 63 874 2095

Address: 15 Innovation Drive, Technopark, Stellenbosch, 7600, South Africa

This document is for informational purposes only. Specifications subject to change without notice.

