

Construction of Galvanized Fireproof Cable Trays



Construction of Galvanized Fireproof Cable Trays



This guide explains the critical steps in fireproof cable trays acceptance, covering coating processes, inspection standards, and more. By following these steps, you can enhance durability ...



Cable trays and busways at floor level or at slab penetrations shall have a waterstop no less than 50 mm in height. At slab penetrations, provide 20-30 mm of firestopping and install a fire ...



The foil, fiber mat and encapsulated screen are mechanically secured together. The units can be assembled on the job site to form a cable tray for protecting control lines in a refinery or...



Cable tray installation must comply with specific technical standards to ensure electrical safety, system reliability, and long-term maintainability. This document outlines the key requirements for cable tray ...



We provide a variety of options that include different materials and finishes, such as powder-coated aluminum, galvanized steel, and fiberglass with intumescent coatings, all designed to improve fire ...

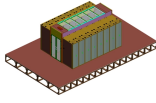

When fitting cable trays and their accessories, the products are cut on site to create changes of direction, adjust sections, etc. Damage can also occur during handling; as a result, both the ...



Cable tray installation must comply with specific technical standards to ensure electrical safety, system reliability, and long-term maintainability. This document ...

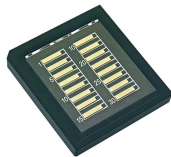

The document outlines the specifications for the supply, fabrication, and installation of various types of cable trays and raceways made from hot-dipped galvanized steel.



This method statement covers the site installation of the cable tray & ladders and the requirements of checks to be carried out.



Our wind certification report provides you with list of acceptable B-Line series cable tray supports, fittings and covers based off of the environmental conditions, cable loading, and type of cable tray in your ...

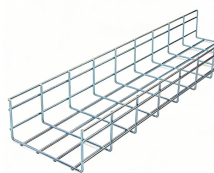

This article will delve into the best cable tray materials for fire-resistant installations, offering valuable insights for professionals ...

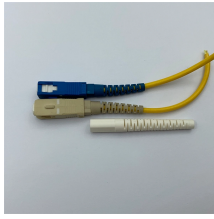

Cable trays and busways at floor level or at slab penetrations shall have a waterstop no less than 50 mm in height. At slab penetrations, provide ...

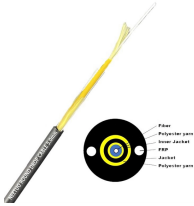

In designing supports for a cable tray system, consideration should be given to the loads associated with future cable additions and any additional loading that may be applied to the cable tray system (e.g., ...

Contact Us

For more information, pricing, or custom solutions, please contact us:

Website: <https://samastersbaseball.co.za>

Email: sales@samastersbaseball.co.za

Phone: +27 63 874 2095

Address: 15 Innovation Drive, Technopark, Stellenbosch, 7600, South Africa

This document is for informational purposes only. Specifications subject to change without notice.

