

Brocade Fiber Optic Switch Cascading and Zone Division



Overview

Zone Configuration of Brocade explains how zoning is used to control communication between hosts and storage in a SAN. This appendix provides basic steps and commands to quickly configure a switch for fabric and possible FICON and cascaded FICON operation. The Switch Configuration Example and. Zone is a standard function on Brocade switches. It is logically divided into different areas, so that devices in different areas cannot be. The Switch most WWN is small is elect. Members: WWN (World Wide Name) numbers of HBAs (Host Bus Adapters), disks. BROCADE, the Brocade B weave logo, Brocade: the Intelligent Platform for Networking Storage, SilkWorm, and SilkWorm Express, are trademarks or registered trademarks of Brocade Communications Systems, Inc. or its subsidiaries in the United States and/or in other countries.

Brocade Fiber Optic Switch Cascading and Zone Division

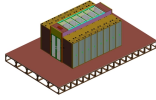

The `cfgcreate` command is used to create a new zone configuration on a Brocade switch. A zone configuration is a collection of zones that define access control between devices within a ...



The FOS REST API allows a user, application, or script to control certain aspects of a Brocade Gen 6 storage area network (SAN) device running Fabric OS 8.2.0 and later or a Gen 7 ...



When the new switch is cascaded with the existing network switch, it is recommended to keep the new switch Zone configuration empty, and then add the Zone configuration after cascading to avoid zone ...



This is an interoperability matrix given by Broadcom and this can be checked in specific version release notes. If the FOS is in line with the matrix, the switches with the designated versions from the above ...



A new Brocade optical switch has a default zone enabled. If it is disabled with the "`defzone --noaccess`" command, then it will be necessary to fine-tune the zones for the safe ...



Zone Configuration of Brocade explains how zoning is used to control communication between hosts and storage in a SAN. This lesson covers zoning concepts, types, and the steps to configure zones ...



HPE Brocade Zoning-SOP - Free download as Word Doc (.doc / .docx), PDF File (.pdf), Text File (.txt) or read online for free. The document outlines the standard operating procedure for configuring ...

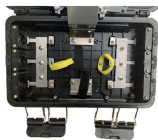

The Switch most WWN is small is elect. Domain ID don't relate. The existing principal switch keep going.



The switches you cascade can be new switches (that is, switches that are offline and have no devices attached), or online switches that are already part of another fabric or Fabric island.



This appendix provides basic steps and commands to quickly configure a switch for fabric and possible FICON and cascaded FICON operation.

Contact Us

For more information, pricing, or custom solutions, please contact us:

Website: <https://samastersbaseball.co.za>

Email: sales@samastersbaseball.co.za

Phone: +27 63 874 2095

Address: 15 Innovation Drive, Technopark, Stellenbosch, 7600, South Africa

This document is for informational purposes only. Specifications subject to change without notice.

